

MANUAL ESPOO CEILING



1. Packaging	page 3
2. Content of the Box	page 4
3. Safety	page 4
4. Positioning & Installation	page 5
5. Operating Instructions	page 6
6. Maintenance	page 8
7. Disposal & Recycling	page 9
8. Bioethanol	page 9
9. Symbols of Awareness	page 10

It is imperative that you read this manual before using the fireplace.

Keep the manual in a safe place for further reference.

It is important that you read the installation and operation instructions and adhere to the safety measures described in this document.

Decoflame ApS cannot be held responsible for any damage caused as a result of non-adherence to these instructions.

Please keep the packaging of your fireplace in case it needed to be sent back to the factory.

1. PACKAGING

Upon receiving the fireplace, take notice of the following:

The fireplace can be packed in:

- 1) A cardboard box with polystyrene inside and placed on a pallet.
- 2) A wooden crate with polystyrene inside and with 50-100mm wooden support for easier handling with a fork- or pallet lift.

Damages of the packaging

Please check the state of the cardboard box or the wooden crate while the courier is still there for visible damages.

If any damages are visible on the packaging it is **EXTREMELY IMPORTANT** to write a report remark about them on the delivery note, in the presence of the courier. Afterwards it is very important to contact Decoflame immediately with the following documentation:

- 1) Photos of all 4 sides of the pallet or wooden crate / cardboard box.
- 2) A description and explanation of the damage.
- 3) A copy or a photo of the delivery note from the driver/courier with the written remark and tracking number.

Contact the courier company immediately and inform them about the damage. Please remember to inform the tracking number.

Hereinafter Decoflame will contact you within the following 3-5 working days.

When you remove the fireplace from the pallet or take it out of the box, please follow the instructions below carefully.

Unpacking the fireplace

Lift or drive the whole box or crate as close as possible to the place where the fireplace is going to be mounted or installed.

Open the wooden crate carefully without causing scratches or damages. Bend the metal fingers open using a screwdriver. Make sure that you slowly and carefully take out the fireplace and place it down on a flat surface without dropping it.

Please make sure that every item or part is wrapped out of the foam foil. If anything is missing, please contact Decoflame immediately or send an email describing the missing parts together with photos of the contents in the box.

It is very **IMPORTANT** to keep the wooden crate or the cardboard, in case the fireplace will need to be returned to Decoflame for service or repair. In the situation where the original packaging is not available anymore, Decoflame can send a new wooden crate. For further information about the costs, please contact Decoflame.

Damages of the Fireplace

If the packaging is not damaged and corresponding to the images sent by Decoflame with the tracking number, the wooden crate/cardboard box can be open.

If you notice any damage on the fireplace, the following information needs to be sent with Decoflame:

- 1) Photos of all 4 sides of the pallet / wooden crate AND the fireplace.
- 2) A description and explanation of the damage.
- 3) A copy or a photo of the delivery note from the courier with the written remark and tracking number.
- 4) Contact the courier and inform them about the damages. Please remember to inform the tracking number.
- 5) Contact Decoflame by email and enclose all documents according points 1-4. Please remember to inform the tracking number and order number - up to 5 digits (The order number can be found on the delivery note from Decoflame or from your retailer).

The deadline for claiming transport damages is maximum 3 working days from the date of delivery.

Contact information at Decoflame:

Decoflame ApS
Vang Mark 2
9380 Vestbjerg
Denmark
Tel. +45 96 30 48 00

(Opening hours: Mon-Thur. 08:00-16:00 and Fri. 08:00-15:30 Danish Time)
Email: logistics@decoflame.dk
Attention line in the email: Order number (Up to 5 digits).

Decoflame refers to The Generals Sales and Delivery Terms. If any questions or doubts, please contact Decoflame or local retailer.

DO NOT

1	DO NOT open the box or wooden crate with sharp objects.
2	DO NOT flip the cardboard box or wooden crate on the sides or on the top. The arrow stickers MUST be followed carefully.
3	DO NOT use a hammer or other hard objects.
4	DO NOT use saws or other similar objects.
5	DO NOT smoke near the fireplace as there might be bioethanol
6	DO NOT lift in the parts which are sensitive to lifting and bending.

2. CONTENT OF THE BOX

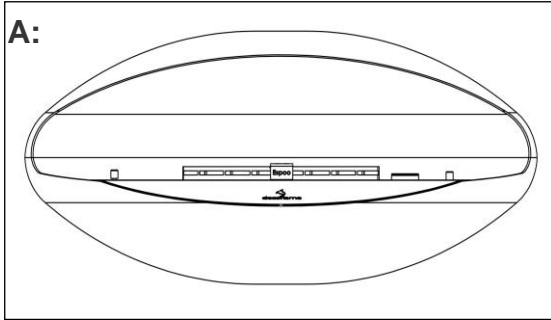

	Pcs.	Content
A:	1	Espoo Ceiling, Ignition button, Espoo logo plate
B:	1	Telescope with 2 bolts & 1 ring
C:	1	Pump
D:	1	Manual

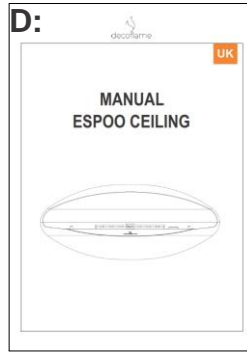
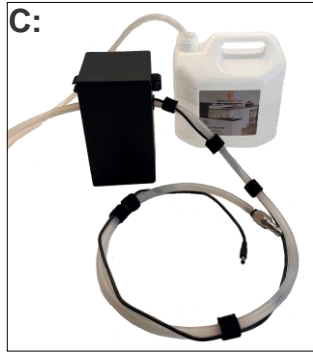
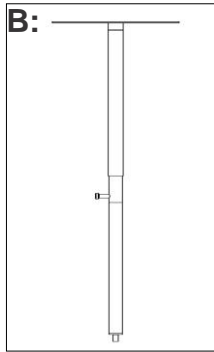

3. SAFETY

Naturally, safety is imperative dealing with open fire. All decoflame® fireplaces are designed, manufactured and quality-tested in Denmark with highest product safety and user-friendliness in mind. Our fireplaces feature a unique and design-protected decoflame® burner which is thoroughly tested and its closing mechanism manually adjusted prior to leaving the production line.

DO NOT amend, add or omit any parts or components of this fireplace as this will void your warranty. Please strictly adhere at all times to all safety measures and installation instructions described in this manual.



Do not fill fuel into the open flame



Do not fill fuel into the hot burner

ATTENTION

1	Choose a position for your fireplace which is not exposed to any draught, as bioethanol is a volatile fluid. In fact, only the vapors of the bioethanol are burning when lit.
2	Choose a solid ceiling surface, where it can hold the weight of the fireplace and telescope.
3	Avoid draughts, as this can cause soot formation and increases the fuel consumption.
4	Ensure that the room in which the fireplace is situated is well ventilated at all times during operation of your fireplace without causing any draught.
5	When lit - the metal of the burner and any glass parts of your fireplace can become hot during use. Avoid contact with those parts to prevent burning.
6	When lit, the glass screens will be warm, as the heat is led upwards. DO NOT place anything on top of your fireplace.
7	NEVER leave the fireplace unattended when it is lit.
8	For safety reasons always keep a safety distance of at least 400mm (16 in) from a lit fireplace.
9	ONLY adults may light and extinguish the flames.
10	You should not touch the flames of the lit fireplace or blow into the flames, as this will cause the flames to escape from the fireplace and they will become uncontrollable. DO NOT touch the surface of the fireplace when lit.
11	When choosing a suitable position for your fireplace please also consider keeping it out of reach of smaller children and pets.
12	Do you have children or pets in the home? If so, make sure an adult keeps an eye on them at all times during operation of your fireplace and never leave your fireplace unattended when it is lit.
13	ALWAYS light and extinguish your Decoflame® fireplace in a safe manner.
14	ALWAYS have the shuttertool and appropriate fire extinguisher nearby the fireplace.



4. POSITIONING & INSTALLATION

ESPOO Ø720x300mm

Heat efficiency:	1.7 - 2.4 kW/h
Weight:	37 kg
Burner volume:	3 liters of bioethanol. Only use bioethanol of at least 96.5% and max 97.5% for DecoFlame® fireplaces.
Burning duration/consumption:	One burner filling will last between 6-10 hours, depending on flame intensity and air flow.

The Espoo Ceiling model is primarily intended for indoors use. It can be positioned, however, on a balcony or terrace as well (it should not be kept exposed to the elements, though). Make sure that the fireplace is placed on a leveled, solid floor surface with a distance of at least one meter (40 in) from curtains, sunshades and similar textiles or other inflammable objects.



Choose a position for the Espoo Ceiling before you light it. **DO NOT** move or lift the fireplace while it is lit.

Also, choose a position for your fireplace which is not exposed to any draught, as bioethanol is a volatile fuel. In fact, only the vapor of the bioethanol is burning when lit. You should not touch the flames of the lit fireplace or blow into the flames, as this will cause the flames to escape from the fireplace and they will become uncontrollable.

DO NOT place any valuable paintings or electronic equipment like TV screens or speakers above the fireplace. The warm air from the fire will rise upwards and might damage anything in its way.

DO NOT recess the Espoo Ceiling fireplace into any niche or place it below shelving.

DO NOT position the Espoo Ceiling pushed against a wall.

You may use this fireplace in conservatories only if their ambient temperature does never exceed normal room temperature.

Always keep a safety distance of at least 40 cm from a lit fireplace.

DO NOT place anything on top of your fireplace.

Do you have children or pets in the home? If so, make sure an adult keeps an eye on them at all times during operation of your fireplace and never leave your fireplace unattended when it is lit.

If in doubt, please contact DecoFlame.

INSTALLATION

Installation of telescope & Espoo fireplace
(best done by three people)

1. Bolt the flange to the ceiling using 5 bolts suitable with the ceiling.
2. Screw assembly nr. 2 on the on the flange and make it tight with hand and make sure it is not loose.
3. Now you have completed the assembly of the telescope, and as last step, you need to lift the fireplace and align the hole on the top with the shaft at the bottom of the pipe nr. 2.
4. We recommend that one/two people lift the fireplace and position it under the telescope, and other person can first place the ring (nr. 4) and then screw the two bolts on (nr. 5) and tighten it until it is locked.

Attention!
Please check for any loose connections.

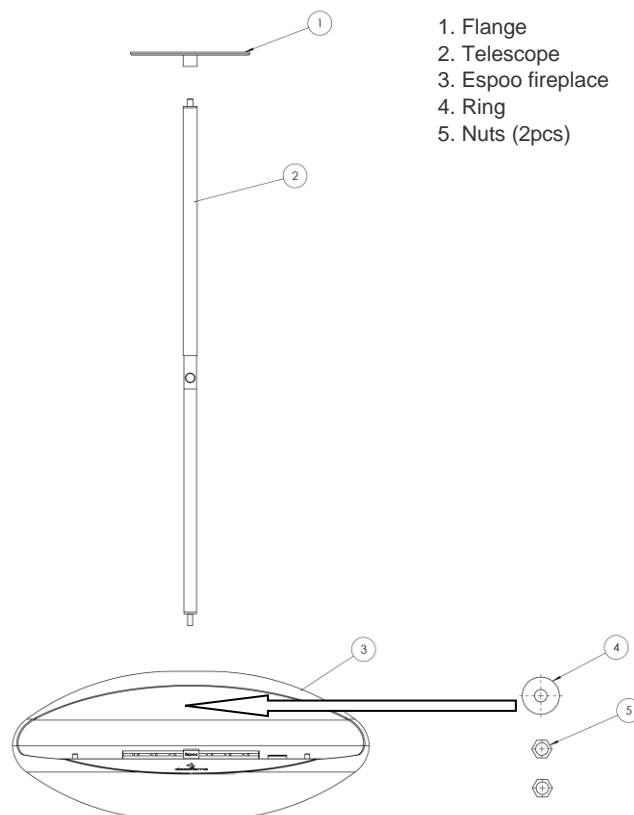

5. OPERATING INSTRUCTIONS

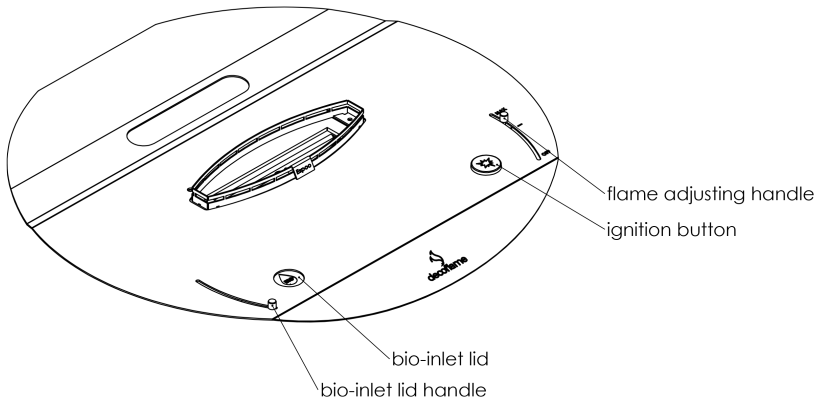

Espoo Ceiling is designed and manufactured exclusively for use with liquid bioethanol of highest purity (96.5 - 97.5%).

DO NOT use any other fuel or materials or bioethanol of inferior quality as this will void your guaranty.

This model is equipped with a pump for filling, so there will be no spill or overspill of the bio during the filling process.

Filling

The fireplace must **ONLY** be lit up when it is cold! **For higher safety this model is equipped with temperature sensor, so, the pump will not be functioning when it is hot.**

Purchase the bioethanol in a specialist shop or online and make sure it is min. 96.5% and max. 97.5%.

We encourage you to buy 3 liters bioethanol as shown here. You can buy it at many retailers or contact DecoFlame.

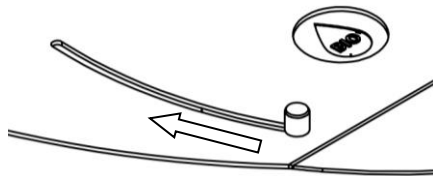

1. Open the lid for fuel inlet, using the handle towards the burner, as shown above.
2. Open a bottle of bioethanol and put the loose-end the hosing in the bottle, the other end with quick release coupling,
3. Push the quick release coupling in, it will click when it is locked in.
4. Now that both ends of the hosing are in the right place you can plug the stick in, once the stick in place, the pump will start functioning,



stick

quick-release coupling

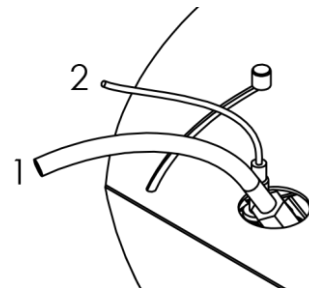

And you just need to wait until the tank is full. This fireplace is equipped with the sensor that it will cut-off the pump once bioethanol reaches certain level inside the tank. This mechanism will help to avoid the risk for overfilling the tank.

IMPORTANT Order should be followed as shown in the picture, coupling should be always connected first, then plug the stick in.

Overfill

An error in pump or sensors, can lead to overfill the tank,

It is important to check the bottom of the fireplace for any sign of bioethanol. There is small hole under the fireplace, which will let the bioethanol to come out in the case of the overfill.

DO NOT light the fireplace in case you have overfilled it!

It is advised to use 3-liter containers to fill the Espoo's tank. In the case of overfill, use a paper towel to wipe off any excess bioethanol from the burner and surrounding surfaces and bottom of the fireplace. And wait 24 hours before light it up again, If error happens again, do not use the fireplace and contact DecoFlame service department immediately for more instructions.

1. Once pump stopped, stick should be unplugged first, and then coupling can be released by pushing the black round button.

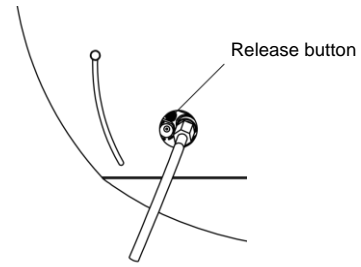

2. Due to safety reasons, fuel inlet lid should be moved back to closed position as shown in the picture.

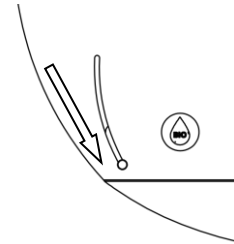

Lightning

To start the fire, fire adjustment handle should be placed on "MAX" position. Espoo ceiling fireplace is equipped with easy spark – ignition system.

So once the adjustment handle is in the "MAX" position, you can light the fire using the ignition button.

IMPORTANT If the bioethanol used to fill the tank is very cold, it should reach room temperature before it can be ignited, in the case where it bioethanol is very cold or room temperature is too low, you may use a gas lighter to start the fire.

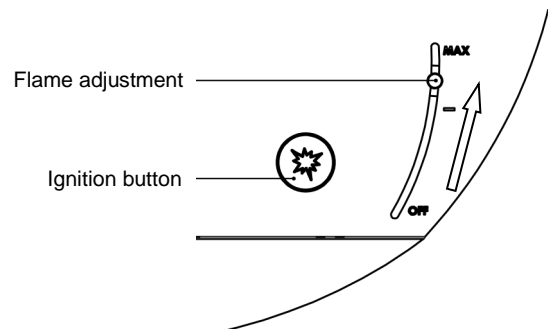

It will take 10-20min before flames reach the intended size. **DO NOT** try to shut the fire in this period. Once the fireplace is started with full tank, it will take 6-10 hours until the whole fuel inside the tank burns out.

IA DCH5 BH

When adjusting the flame on your Espoo fireplace, ensure to set it to the marked '1/3' level as a minimum. It is crucial that you do not adjust the flame lower than this point to reduce the flame size, as it can affect the fireplace's functionality and safety.

Extinguish

Should it be necessary to extinguish the fire before the burner is empty, set the adjustment handle to 1/3 position between "MAX" and "OFF". Then wait 1 minute before shutting down the fire completely. After 1 minute, move the adjustment handle to "OFF" position. The fire should be extinguished immediately. Refer to the picture below.

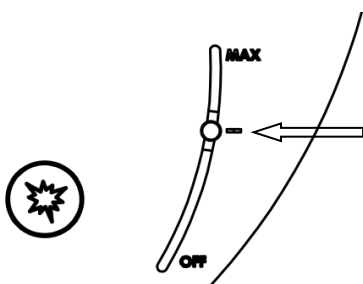

Step 1: hold in 1/3 position for 60 seconds.

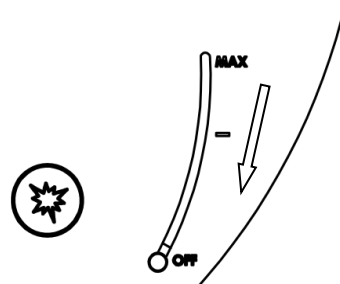

Step 2: extinguish the fire by moving the arm to off position.

6. MAINTENANCE

Refilling

Under any circumstances **DO NOT** try to refill the burner when it is in use or still hot from previous use.

For safety reasons, this fireplace is equipped with temperature sensor, which will prevent pump from functioning while the fireplace is hot. Needs to wait around 20-30mins before fireplace cools down, then it will be ready again to refill.

Pump

Espoo ceiling package including a pump to fill the tank. This pump is battery-driven, so it is important to keep an eye when the battery is depleted. Battery should be replaced with a new one. Depends on the type and brand of battery, it should last for 20-30 times refilling. The battery is used for this pump is a 9V and should be replaced as shown below:

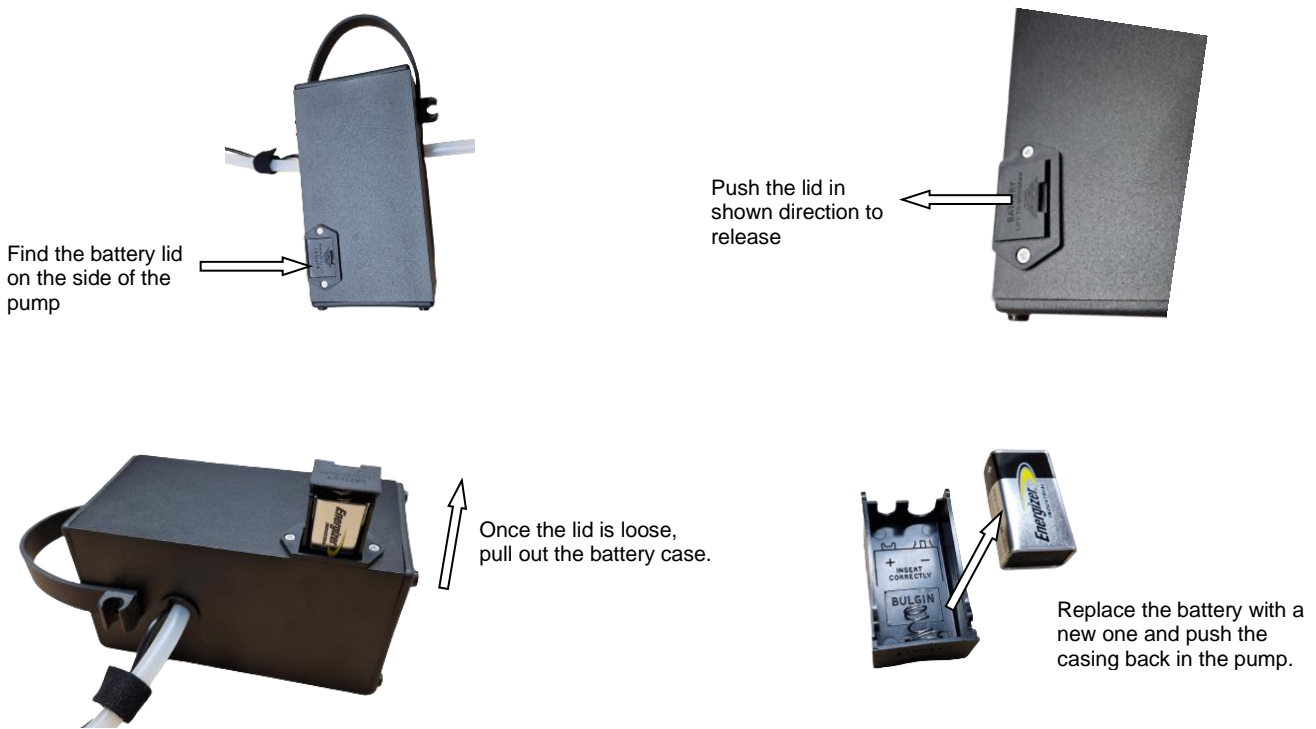

Ignition System

For higher safety, Espoo is equipped with ignition system, which can start the fire without using the lighter.

It is important to note that ignition system will be functioning if the bioethanol and fireplace are in room temperature.

This ignition system using an AAA battery to generate spark. And depend on the battery type should last minimum 5-6 months.

In the case of low battery level, replacing of battery will be as shown below:

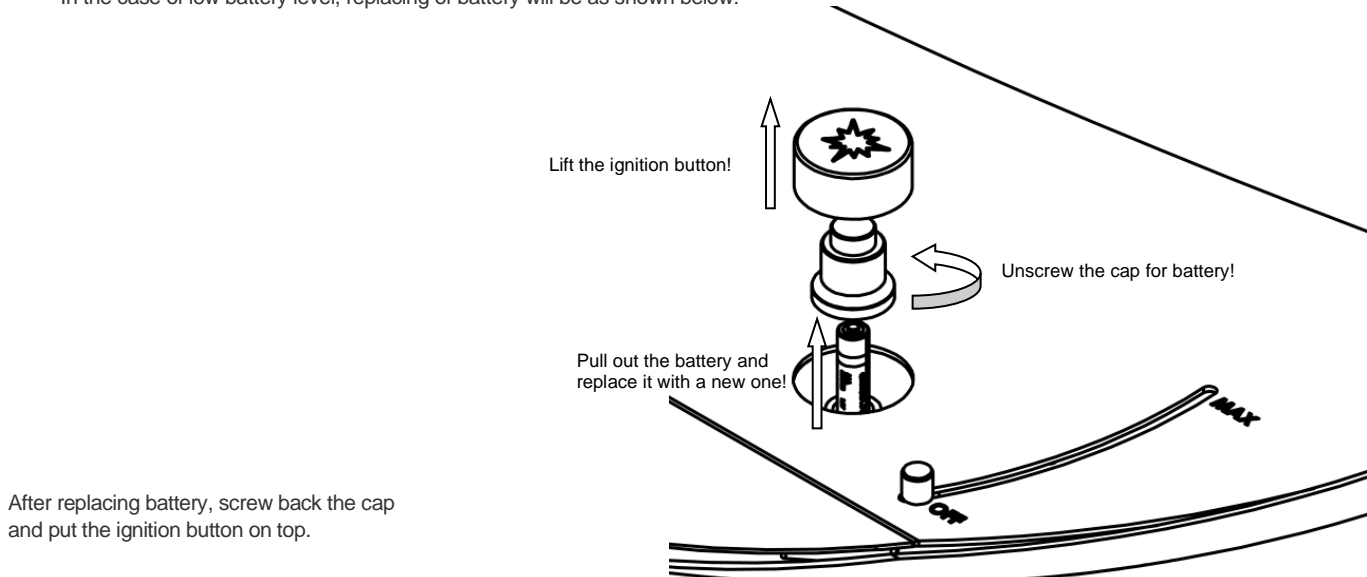

7. DISPOSAL AND RECYCLING

Espoo is made of powder coated steel and brushed steel. If you wish to dispose of the appliance, please adhere to the regional rules and regulations. You will find that most parts of your Decoflame fireplace can be recycled.

8. BIOETHANOL

Purchase the bioethanol in a specialist shop and make sure it is min. 96.5% - to max 97.5 %.

BIOETHANOL IS EXTREMELY FLAMMABLE!

Storing conditions

Always thoroughly follow the instructions on the packaging of the bioethanol. The bioethanol must be stored safely and out of the reach of children!

Only store in original and correctly labeled containers. Keep containers tightly closed. Store in a cool, dry and ventilated room away from ignition sources, oxidizers and non-compliant materials. Provide preventive measures against the generation of static charge. The bioethanol must be at room temperature before it can be ignited.

Safety measures

Preventive measures: Avoid inhalation of vapors. Avoid contact with eyes, skin and clothing. Persons who are prone to skin allergies or lung disease should not come into contact with bioethanol. We recommend that people with breathing problems or asthma keep a window opened during the use of their bioethanol fireplace. Use standard precautions for working with chemicals.

Measures to prevent fire

Due to the high flammability of the product strictly follow the special fire protection measures at the storage location. Protect containers from overheating. Bioethanol should be stored in a fireproof container and out of the reach of children.

Prevent bioethanol from coming in contact with heat, sparks and flames. Keep away from non-compliant materials such as metal or alkali.

Flash point 13°C / boiling point 78°C. The fireplace can be difficult to start, if it is below room temperature.

DO NOT

1	DO NOT use any other fuel, materials or bioethanol of inferior quality as this will void your guaranty.
2	DO NOT use any sentences or oils to your bioethanol as this will void your guaranty.
3	DO NOT mix bioethanol with other fuels as this will void your guaranty.

Denatured Bioethanol is classified as:

Flammable Liquid Class 1B (for Flammability)

Class 3 PGII (for Transportation)



UN1170 (Identification Code)

Regulated by various standards around the world.

You must familiarise yourself and comply with these regulations in order to safely and legally store, handle, decant and use this fuel.



ATTENTION BIOETHANOL

1	DO NOT light the bioethanol if you have overfilled the burner.	
2	DO NOT fill the burner with bioethanol until the temperature is below 40 degrees Celsius.	
3	DO NOT smoke when filling the burner with bioethanol.	
4	DO NOT under any circumstances – refill the burner when it is in use or still hot from previous use.	
5	DO NOT attempt to blow out the fire - or blow into the flames, as this will cause the flames to escape from the fireplace and they will be uncontrollable	
6	DO NOT cover the fireplace when lid.	
7	DO NOT place any inflammable materials or clothes on the fireplace.	
8	DO NOT place anything on top of the burner.	
9	DO NOT decorate the burner with ceramic pebbles or other items as this will lead to overheating and damage to the glass surround.	
10	DO NOT place any pebbles or stones on the burner as these will crack and might cause injury or damage to the fireplace.	
11	DO NOT place any ceramic logs or pebbles on top of the burner as these will increase the combustion temperature, which increases the fuel consumption and might cause undesired micro-particles in the room air.	
12	DO NOT place any valuable paintings or electronic equipment like TV screens or speakers above the fireplace. The warm air from the fire will rise upwards and might damage anything in its way.	
13	DO NOT use the burner as a barbecue! It is not suited to roast anything.	
14	DO NOT touch the flames.	

9. SYMBOLS OF AWARENESS



Do not fill fuel into the open flame



Do not fill fuel into the hot burner



Do not touch the flames



Health hazard



Do not position the fireplace near combustible items



Protect fireplace against draft



No smoking



Never fan the fire



Keep suitable extinguishing agent ready.



Warning - flammable material



Adhere to instructions about fuel and fireblanket



The package will include:

	Pcs.	Content	
A:	1	Espoo Ceiling: Ignition button Espoo logo plate 2x M10 bolt Ring	
B:	1	Telescope	
C:	1	Pump	
D:	1	Manual	

Rating plate:

Decoflame ApS

Date

*Follow the Fire Authorities and national and local requirements regarding bioethanol fireplaces.
Subject to typographical errors and technical errors. Decoflame ApS reserves the right to make changes without notice.
We refer to Decoflame's General Terms of Sale and Delivery.
V10723*